



### Progress Report – Spring 2006

#### Over 60 Percent of the Funds Raised

A \$1 million grant from **Kaiser Permanente** in January advanced the capital campaign enormously, and represents a powerful statement about Kaiser's commitment to partnering with the disability community. The Ed Roberts Campus is delighted to be able to collaborate with the health care giant to increase programs and visibility for all people with disabilities in the region.

In February, a wonderful pledge of \$400,000 from the **Manuel D. and Rhoda Mayerson Foundation**, located in Cincinnati, highlights the importance of the project as a national model. The Mayerson Foundation, through its significant granting of funds to open access to Cincinnati museums, theaters, playgrounds and schools, as well as its support of the Inclusion Network, has brought disability issues to the forefront in Cincinnati. "The Mayerson Foundation has traditionally focused its resources in its hometown, but broke tradition to be part of the innovative collaborative vision" of the Ed Roberts campus, stated TMF President Neal Mayerson.

See "Funds" on page 3 ►

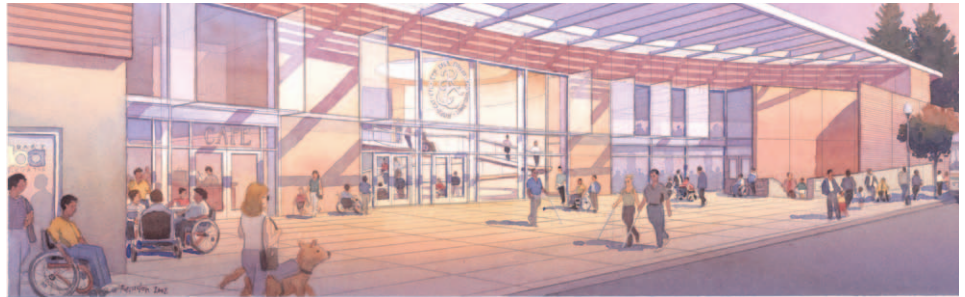

#### Campaign Committee Strengthened With New Members

The Capital Campaign Committee welcomed two new members in 2006. David Lawrence, retired CEO and president of Kaiser Permanente, remains active in health care and serves on several corporate and philanthropic boards. Arlene Mayerson, directing attorney at the Disability Rights Education and Defense Fund, is a board member of the Manuel D. and Rhoda Mayerson Foundation. We are fortunate to have their energy and commitment in the final push to raise the remaining funds. ❖□

*"I'm delighted to be able to help make the final push for this worthy project. The funds are coming in. But to put the shovel in the ground, we need to raise the \$11 million in private sector funds quickly – and that's the task the Campaign Committee has taken on."*  
– David Lawrence



From left to right: Arthur Combs, ERC; Pam Ulmer, Kaiser Permanente; Dmitri Belser, ERC; Yvette Radford, Kaiser Permanente

## Public Sector Support

### The Need for Transit-Accessible Services

According to a 2003 U. S. General Accounting Office study, people with disabilities nationwide are unable to connect with the services they need. Five and a half million people in the United States, because of an impairment or health concern, do not drive. The Ed Roberts Campus will be the first transit-oriented development to provide seniors and the disability community with a wide range of services and opportunities at a location they can easily get to. For this reason, the public sector supports the Campus as a model and a prototype for service delivery.

Representative Barbara Lee (D-Oakland, CA) has been instrumental to getting public sector support, because she recognizes the Ed Roberts Campus as a project that is national in scope. She comments: “The Federal Government plays an important role in empowering people with disabilities to be full participants in society. As a result [of the Ed Roberts Campus], people living throughout the region

will have access to programs that will enable them to obtain needed health care, education, job training and other services in order to achieve their life and work goals.”

On the Senate side, the ERC is grateful to Senator Barbara Boxer for carrying our request for health and human services funds for the Campus, and to Senator Tom Harkin, who supported her request. Senator Harkin is a longtime supporter of equal opportunity for people with disabilities and is the former chair of the subcommittee on disability policy.

On the local front, the city of Berkeley realizes the potential of this project and has supported us from day one. Just last month, the City Council passed resolutions naming the Ed Roberts Campus its first priority for federal funds in 2007. The Campus is seeking \$2.5 million from federal transportation sources; if awarded, this funding would achieve the Ed



*Senator Tom Harkin with Julia Epstein from the ERC Board and her two daughters at Union Station for the 25th DREDF/15th ADA Anniversary Celebration in July 2005. (Photo: Sharon Farmer)*

Dianne Feinstein and Barbara Boxer to support this effort.

The project received a major boost in January when the Alameda County Congestion Management Agency (ACCMA) awarded it a \$1.2 million Transportation for Livable Communities (TLC) grant after a highly competitive process. These funds will be used to improve the transportation infrastructure at the Ashby BART Station, improve transit interconnectivity, and increase access and safety for people with disabilities, pedestrians and bicyclists.

The ERC is continuing to work with the ACCMA and the Metropolitan Transportation Commission to seek additional transit funds to support other essential access and safety enhancements such as pedestrian pathways and a public plaza, pedestrian-scale lighting, street trees and landscaping, Adeline Street crosswalk and median improvements, and a bus shelter with a transit information kiosk. ❖

Requests are being submitted to Congresswoman Barbara Lee and California Senators

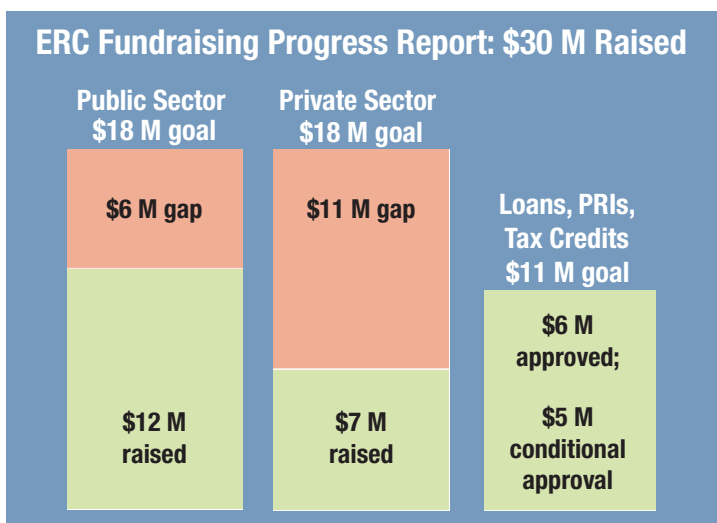

## The Ed Roberts Campus Will Draw Thousands of Bay Area Residents

A recent survey of the Ed Roberts Campus partners revealed that together they conservatively expect to double the numbers of clients they serve when the new facility opens, with about 30,000 people a year utilizing the center. Many of these people will take advantage of several services during one visit and many others will return daily, weekly or monthly for follow-up services and programs.

The partners cited the following attributes of their new quarters to account for the increase:

- Accessibility to public transit
- Availability of meeting rooms and conference spaces
- Referrals from other partners
- Visibility to the public
- Collaborative projects and programs

The agencies that are planning new programs, such as the fitness center and the child development center, will vastly increase the number of clients served. ❖ □

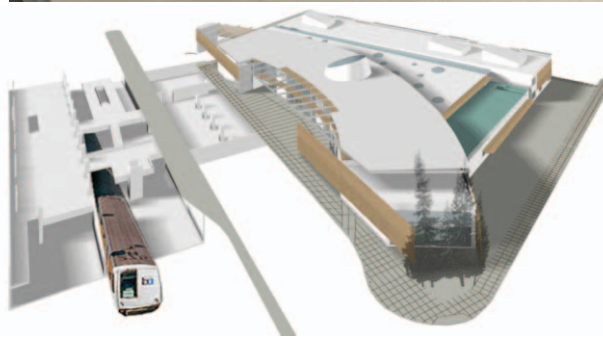

*A cutaway model and a rendering of the Ed Roberts Campus and the BART Station below*

### Funds...

*(continued from front)*

These two generous grants, along with a \$200,000 gift received at the close of 2005 from the **Y&H Soda Foundation**, bring the fundraising significantly closer to its goals. The Ed Roberts Campus would also like to acknowledge gifts from the **Morris Stulsaft Foundation** and the **Thomas J. Long Foundation**.

To date, our gifts, pledges and available financing cover over 60 percent of the cost of the building. Discussions are now under way with other major funders to gain their support for the Campus. A new campaign

for corporate support is gaining momentum, with the 2005 gift from **Pacific Gas & Electric** of \$100,000 leading the way. ❖ □

### Private Sector Gifts

The Wayne and Gladys Valley Foundation  
Kaiser Permanente  
The Bernard Osher Foundation  
The California Endowment  
The NEC Foundation of America  
The Manuel D. and Rhoda Mayerson Foundation  
The Y&H Soda Foundation  
Pacific Gas & Electric Company  
The San Francisco Foundation  
The William Randolph Hearst Foundations  
True North Foundation  
The Thomas J. Long Foundation  
Tides Foundation  
East Bay Community Foundation  
VanLobenSelsRembeRock Foundation  
Evelyn and Walter Haas Jr. Fund  
Bank of America Foundation  
Friedman Family Fund  
Charity Begins at Home

### Timeline:

#### Groundbreaking Scheduled for 2007

With the use permits secured and the architectural plans nearly complete, the Ed Roberts Campus is scheduled to break ground in 2007. The Board of Directors and the Capital Campaign Committee are focused on raising the remaining funds in the next year from both private and public sources. Keeping to this aggressive schedule is essential to control construction costs, which have increased for the project from \$35 million to \$47 million over the past two years, due to the rising prices for steel and concrete. ❖ □

## Campus Hires First Executive Director

The Ed Roberts Campus welcomes Lorne Buchman as its first executive director. Buchman has worked with the ERC Board of Directors for two years, developing the project's business and financial plans. He is uniquely qualified to advance the project in its final year before construction.



For the past few years, Buchman has developed multitenant, nonprofit buildings by forming partnerships between nonprofit organizations and private investors, such as San Francisco's Ninth Street Media Arts Consortium and the Museum of Quilts and Textiles in San Jose. "His experience in the field of multitenant projects and nonprofit management makes him a stellar choice to lead the Campaign," says Board Chair Dmitri Belser.

Buchman is equally enthusiastic. "After working with the Ed Roberts Campus team, I knew that this was a project that I wanted to see through to fruition. The organizations are so effective, the leadership so focused, and the project so extraordinary that I know that together we will create a new standard for nonprofits and building design."

From 1992-1999 Buchman was president of the California College of Arts and Crafts, an independent college of art and design in the Bay Area. During his tenure, he created a highly acclaimed new campus in San Francisco and established innovations in academic and public programs. ❖

## Passing of the Baton at ERC Board

### Dmitri Belser Replaces Jan Garrett as Chair

Dmitri Belser, Executive Director of the Center for Accessible Technology, was elected in February as the new chair of the Board of Directors. Belser is the ERC's fourth chair and takes over from Jan Garrett, who has led the group since 2003.



"Our goal is clearly in sight. I'm honored to be leading the 'bell lap' of the race to the Ed Roberts Campus. The capital campaign has built up a momentum that will carry us to our goal of breaking ground next spring," he says.

For Belser the Campus is first and foremost about strengthening outcomes by working together. "The level of collaboration will be great when the Ed Roberts Campus partner organizations are co-located. Joint efforts have already begun, and we can see the results for our clients. For example, two ERC organizations are working together with parents who are trying to get their kids services in school. By linking our resources together, these families get the support of both agencies and become more effective advocates for their kids in the process. This is a model for how disability services should work. What more fitting tribute could there be to the life of Ed Roberts?"

Belser has worked in the disability community for over 25 years. ❖

## The Ed Roberts Campus Has a New Address!

2547 8th Street  
Suite 12A  
Berkeley, CA 94710

New Telephone Number:  
510-841-3224

Our web address remains the same:

[www.edrobertscampus.org](http://www.edrobertscampus.org)